

CONTRACT: I-175761
NAD-83, GEOID 12A
PROJECT COORDS
ARC GIS: 10.3

CERTIFICATE OF SURVEY: PT. OUTLOT 257 & HOLIDAY PARK CONDO'S CITY OF PERRYSBURG, WOOD COUNTY, OHIO

REFERENCE DOCS

- HOLIDAY PARK CONDOMINIUM PLANS, 2005
- HOLIDAY PARK RECORD PLAT, 1966
- HOLIDAY PARK LOT 1, LEWANDOWSKI ENGINEERS, 2006
- HOLIDAY PARK LOT 10, LEWANDOWSKI ENGINEERS 1997
- HOLIDAY PARK LOT 6, FREELS, 1977
- HOLIDAY PARK LOT 7, FREELS, 1977
- HOLIDAY PARK LOT 8, FREELS, 1977

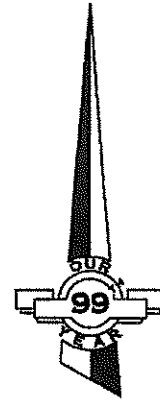
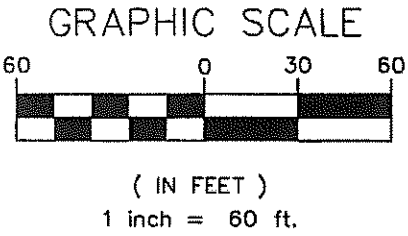

N 6256.63
E 5472.25

FD. REC. 1/2"
I.P.I.P.E

1. FD 1/2" I.P.I.P.E
ON LINE
2. FD. 1/2" I.P.I.P.E
0.96' NW.

SET 1/2" GALV.
STEEL PIPE

N 5972.37
E 5173.39

FD 1/2" I.P.I.P.E
ON LINE

8' UTIL
ESM'T
PER PLAT

8'
8' UTIL
ESM'T
PER PLAT

N60°18'16"W
40.00'

SET 1/2" GALV.
STEEL PIPE

N 5836.27
E 5095.77

P60-400-
040306002000

LOT
10

FD. 3/8" I.BAR,
BENT 0.12' NW

N 5816.46
E 5130.51

SET MAG. NAIL

751.83'
S00°26'49"W

HELEN DR.
N29°41'44"E
60.00'

SET 1/2" GALV.
STEEL PIPE

N 5784.15
E 5066.04

N29°41'44"E
60.00'

FD. MAG.
0.13' SE

N 5764.34
E 5100.79

FD. 3/8" I.BAR
ON LINE

HOLIDAY PARK

P60-400-090101012211

SET 1/2" GALV.
STEEL PIPE

N 5729.30
E 5034.76

P.O.B. HOLIDAY
PARK CONDO'S.
PT. BEING
1006.89' FROM
SR. 20 R/W

N29°41'44"E
137.00'

N. LINE HOTEL PROPERTIES
O.R.3167 P.375
N60°20'30"W
135.76'

ACCEPTED 5/8"
I.BAR "ARJ"

N 5662.12
E 5152.73

N60°11'16"W
92.79'

N 5680.68
E 5162.85

FD. REC. 1/2"
I.P.I.P.E. LE
SURVEY 33240

R=60.00'
L=141.67'
T=145.88'

Δ=135°17'11"

CB=N67°09'24"W
CD=110.98'

70' BLDG. LINE

S28°35'51"W
21.13'

N44°48'29"W
185.67'

1. SET 1/2" GAL
STEEL PIPE
2. FD. 3/4" I.P.I.P.E
0.48' N. & 0.72' W.

N 5504.82
E 5466.39

CERTIFICATION

WE HEREBY CERTIFY THAT WE HAVE MADE A SURVEY
OF THE PREMISES SHOWN HEREON AS RECORDED IN
WOOD COUNTY DEED VOLUME 2999, PAGE 528 AND
THAT THIS DRAWING IS A CORRECT PLOT THEREOF.
ALL 1/2" GALVANIZED STEEL PIPE SET BY
LEWANDOWSKI ENGINEERS ARE CAPPED WITH THE
COMPANY NAME AND P.L.S. No. 7476.

Matthew D. Lewandowski
REGISTERED SURVEYOR, STATE OF OHIO #7476

N 5548.95
E 5293.69

SET MAG.
NAIL

1. SET 1/2" GALV.
STEEL PIPE

N 5505.86
E 5395.98

2. FD. 1/2"
I.P.I.P.E
0.03' S. &
0.28' W.

70.32' P.
70.43' M.

N89°08'58"W

60'
R/W

HOLIDAY LN.

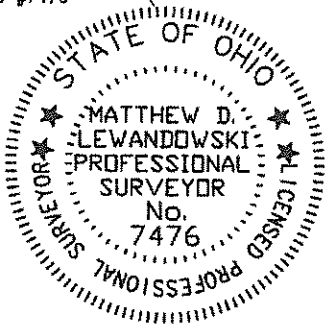
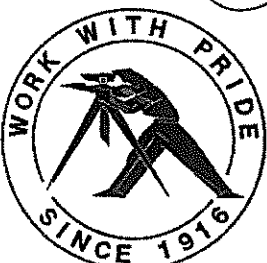

LEWANDOWSKI ENGINEERS

CIVIL ENGINEERS & SURVEYORS
THE CHIEF BLDG 234 N. ERIE ST.
TOLEDO, OHIO, 43604
LEWANDOWSKIENG.COM
OFFICE: 419.255.4111