

Middleton  
A  
560

NW CORNER,  
SW 1/4,  
SECTION 16

DALE R & DIANE M BROWN  
OR VOL 2728 - PG 876  
38.28 ACRES (RECORDED)  
PT. PN. J36-611-160000013000

BOCKRATH  
GAB-E/S8306

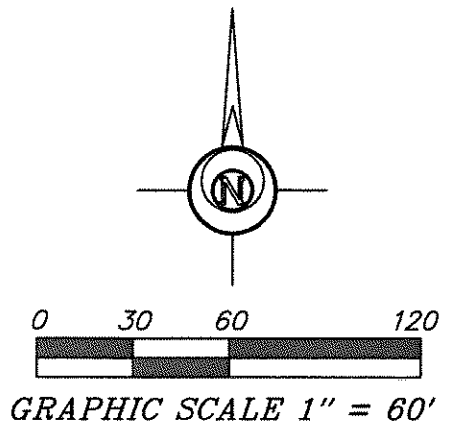

NOTE: ID CAP SET = REBAR  
PLASTIC CAP STAMPED  
"BOCKRATH GAB-E/S8306"

**LEGEND**

- 5/8 INCH REBAR WITH ID CAP SET
- 1/2 INCH BENT IRON PIN FOUND
- ⊗ RAILROAD SPIKE FOUND
- 1/2 INCH IRON PIN FOUND
- ⊙ 1/2 INCH IRON PIPE FOUND
- 5/8 INCH IRON PIN FOUND
- (D) DEED DISTANCE
- (M) MEASURED DISTANCE

NOTE:  
THE 5/8" IRON PIN AT THE NW  
CORNER, SW1/4, SEC. 16 AND RAILROAD  
SPIKE AT THE SW CORNER, SW1/4, SEC.16  
ARE ACCEPTED AS THE NW1/4 POST, SW1/4,  
SEC.16 AND SW1/4 POST, SW1/4, SEC.16,  
RESPECTIVELY, AS SHOWN ON THE DUNBRIDGE  
ROAD SURVEY #71-MDD DATED JUNE, 1976  
IN THE WOOD COUNTY ENGINEER RECORDS.

NOTE:  
THE 1/2" IRON PIPE AT THE SE  
CORNER, SW1/4, SEC. 16 IS  
ACCEPTED AS THE N1/4 POST, SEC.21  
AS SHOWN ON THE TESAR SURVEY  
#6111600-0004 DATED MAY, 1942  
IN THE WOOD COUNTY ENGINEER  
RECORDS.

THIS SURVEY WAS PERFORMED WITHOUT THE  
BENEFIT OF A TITLE EXAMINATION. BEYOND  
THE DEED DOCUMENTS CITED ON THE SURVEY  
DRAWING THERE MAY BE RECORDED OR UN-  
RECORDED EASEMENTS AND/OR  
ENCUMBRANCES BENEFITING OR ENCUMBERING  
THE SURVEYED PROPERTY WHICH ARE NOT  
SHOWN ON THIS DRAWING.

C/L DUNBRIDGE ROAD (60' R/W)  
N 00°58'37" E 2085.07'  
(ASSUMED BEARING)

WEST LINE, SW 1/4, SEC. 16  
309.35'

131.85' (M)  
129.60' (D)

1775.72'

177.50'

131.85' (M)  
129.60' (D)

POB  
SW CORNER,  
SW 1/4,  
SECTION 16

SW CORNER,  
SW 1/4,  
SECTION 16

DUSTIN D BROWN  
OR VOL 2728 - PG 882  
39 ACRES (PER TAX RECORD)

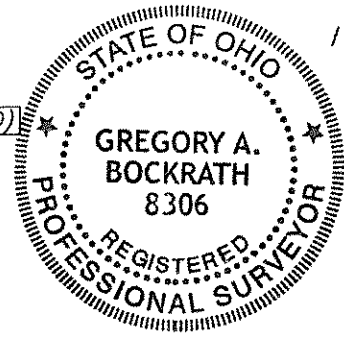

I HEREBY CERTIFY THIS TO BE A SURVEY MADE UNDER MY SUPERVISION  
AND THAT THE MONUMENTS ARE FOUND AND/OR SET AS INDICATED.

8-26-15  
Date

*Gregory A. Bockrath*  
Gregory A. Bockrath, P.S.  
Registered Surveyor No. 8306.  
115 S. Fair Avenue, Suite A  
Ottawa, Ohio 45875  
419-523-5789

**COMBINATION PARCEL**  
**3.000 ACRES**  
(0.213 AC. IN DUNBRIDGE RD. R/W)

DUSTIN D BROWN  
OR VOL 3334 - PG 770  
1.720 ACRES (RECORDED)  
PN. J36-611-160000013001

**1.280 ACRE PARCEL**  
(0.091 AC. IN DUNBRIDGE RD. R/W)  
PT. PN. J36-611-160000013000

S 88°27'23" E 422.00'

N 88°27'23" W 422.00'

S 88°22'08" E 422.01'

SOUTH LINE, SW 1/4, SEC. 16

S 88°22'08" E 2212.15'

S 00°58'37" W 177.50'

S 00°58'37" W 132.50'

10.00'

RETRACEMENT SURVEY FOR:  
DUSTIN BROWN

PART OF THE SW 1/4 OF THE SW 1/4  
OF SECTION 16, T6N - 11E,  
MIDDLETON TOWNSHIP  
WOOD COUNTY, OHIO

**BOCKRATH & ASSOCIATES**  
ENGINEERING and SURVEYING, LLC  
115 S. FAIR AVENUE, SUITE A - OTTAWA, OH 45875  
PHONE: 419-523-5789 - FAX: 419-523-5799

1  
1

Middleton  
A  
560