

JACKSON 302

HENRY-WOOD CO. LINE RD.

W LINE, SW 1/4, SEC. 31

N 01°40'09" W

NW COR.
SW 1/4, SW 1/4
SEC. 31

SURVEY REF:
JACKSON 43
JACKSON 56
JACKSON 296
WOOD CO COR. REFS
JACKSON 774

LEGEND
A = BOAT SPIKE FOUND
B = RAILROAD SPIKE FOUND
C = IRON PIPE FOUND
D = POINT ESTABLISHED
E = MAG NAIL SET
F = 5/8" X 30" IRON PIN W/REF CAP SET, (INSCRIBED S-7758)

P.O.C. = Point of Commencement
P.O.B. = Point of Beginning

I hereby certify this survey and notes to be correct to the best of my knowledge.

Douglas W. Eis
Douglas W. Eis
Registered Surveyor No. 7758
16-883 St. Rt. 281
Holgate, Ohio 43527
(419) 762-5468
February 21, 2022
Survey No. B3076-Wo-J-3-30-22



MARK R. & MELODY S. DREWES
OR 3344 PG. 157
PPN: G24-309-310000010000

W LINE, SE 1/4, SW 1/4, SEC. 31

N 82°07'10" W

255.46'

30'

S LINE, SW 1/4, SEC. 31
299.80'
S 88°04'41" W
(ASSUMED BEARING)

N 87°56'04" E
N LINE, S 1/2, SW 1/4, SEC. 31

1487.13'

PLAT OF SURVEY
BEING A PART OF THE SOUTHWEST QUARTER (1/4) OF SECTION 31,
TOWNSHIP 3 NORTH, RANGE 9 EAST, JACKSON TOWNSHIP,
WOOD COUNTY, OHIO

FOR: WILLIAM E. SMITH
DEED REF: DV 644, PG. 531
PPN: G24-309-310000011000

2.006 AC.
-0.206 AC R/W
1.800 AC. NET

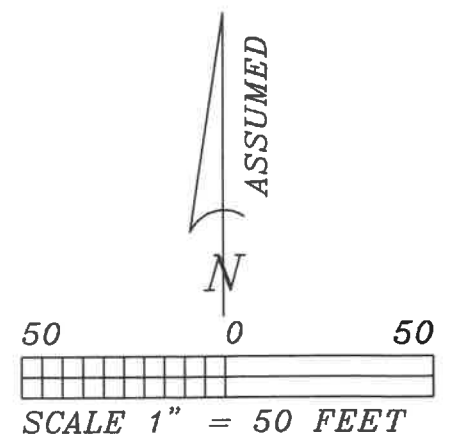

SW COR.
SW 1/4
SEC. 31

660.00'

657.29'

1325.87'

N 01°40'08" W

1038.76'

N 85°48'05" E
300.11'

S 01°40'09" E
272.38'

P.O.B.

1147.38'

SE COR.
SW 1/4
SEC. 31

P.O.C.

E LINE, SW 1/4, SEC. 31

N 00°03'28" E

1325.01'

HANCOCK-WOOD CO. LINE RD. 60' R/W

JACKSON 302