

OF THIS PROJECT OR FOR ANY OTHER PROJECT, ANY REUSE WITHOUT WRITTEN VERIFICATION AND ADAPTATION BY THE ENGINEER, ARCHITECT OR SURVEYOR FOR THE SPECIFIC PURPOSE INTENDED WILL BE AT THE USER'S SOLE RISK AND WITHOUT LIABILITY OR LEGAL EXPOSURE TO THE ENGINEER, ARCHITECT OR SURVEYOR.

FILE No. I:\990300\00190\9903190.dwg 09/17/20 15:51--coders

# Boundary Survey for Parcel Split

## Part of the east and west halves of Fractional Section 13, T6N, R11E, Webster Township, Wood County, Ohio

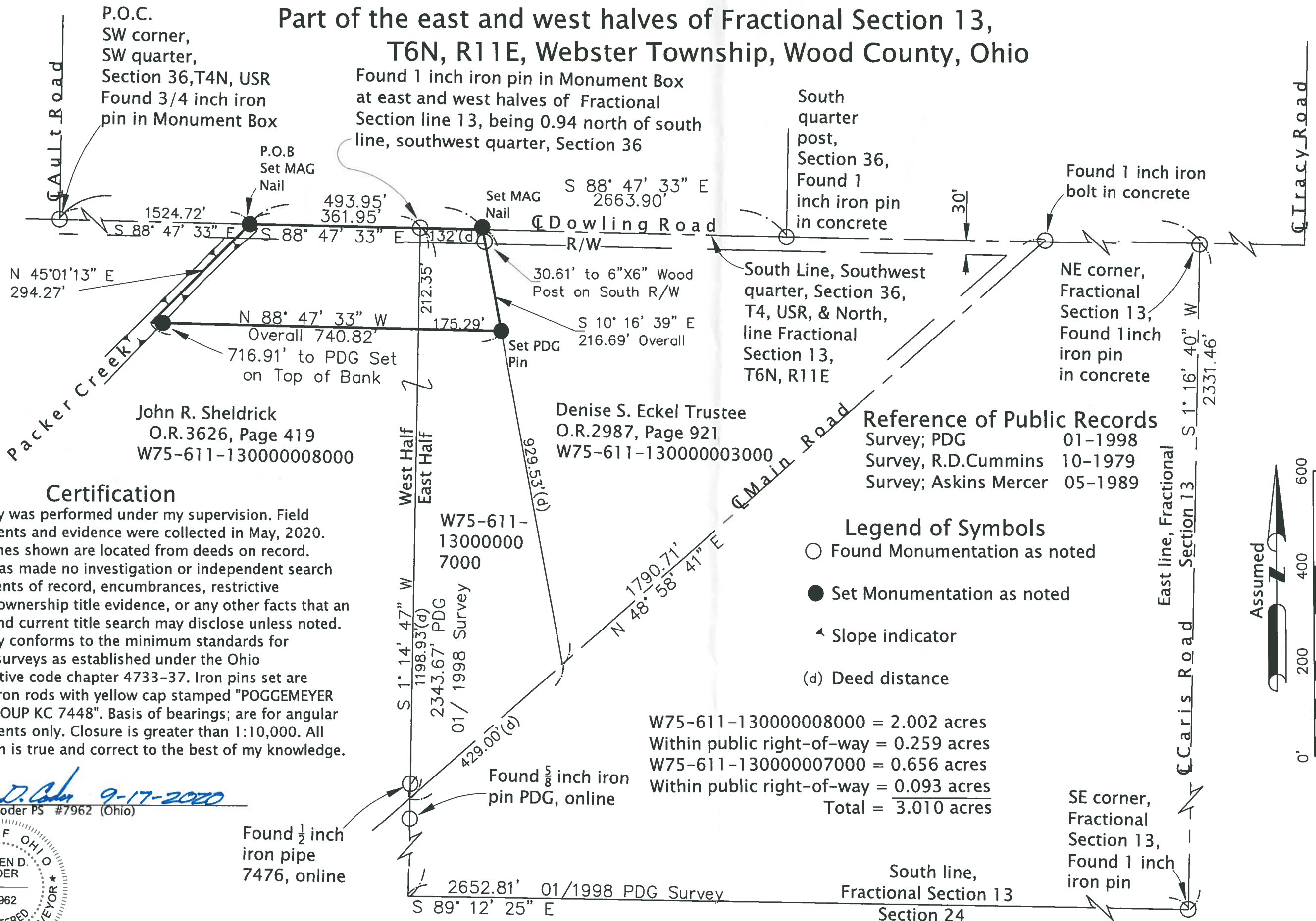

### Certification

This survey was performed under my supervision. Field measurements and evidence were collected in May, 2020. Property lines shown are located from deeds on record. Surveyor has made no investigation or independent search for easements of record, encumbrances, restrictive covenant, ownership title evidence, or any other facts that an accurate and current title search may disclose unless noted. This survey conforms to the minimum standards for boundary surveys as established under the Ohio administrative code chapter 4733-37. Iron pins set are 5/8"x30" iron rods with yellow cap stamped "POGGEMEYER DESIGN GROUP KC 7448". Basis of bearings; are for angular measurements only. Closure is greater than 1:10,000. All information is true and correct to the best of my knowledge.

*Steven D. Coder* 9-17-2020  
Steven D. Coder PS #7962 (Ohio)

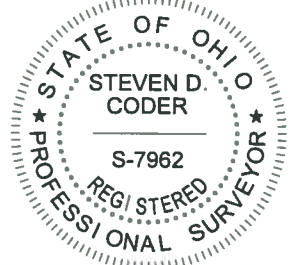

WEB. 379

**POGGEMEYER DESIGN GROUP, INC.**  
ARCHITECTS SURVEYORS ENGINEERS  
1168 NORTH MAIN STREET BOWLING GREEN, OHIO 43402  
(419) 352-7537

**Boundary Survey For Parcel Split**

John R. Sheldrick  
310 Hartman Rd.  
Woodville, OH.

REV1	
REV2	
REV3	
REV4	
REV5	
REV6	
REV7	
1 of 1	
JOB NUMBER	9903-190

WEB. 379