

2.000 AC

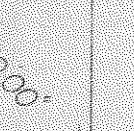

Handwritten notes: "1/4 sec 16", "1/4 sec 16", "1/4 sec 16"

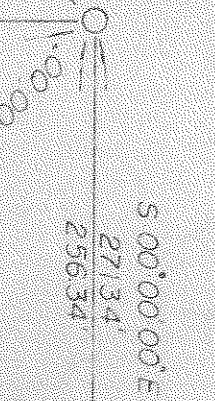
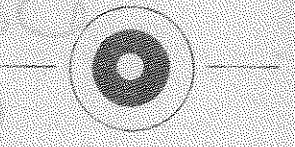

SE Cor. SW 1/4, SW 1/4, Sec. 16 - fd iron pin

We hereby certify the above described parcel was surveyed JANUARY 1979. All distances are in feet and decimals thereof.

Larry D. Askins
Larry D. Askins - Reg. Surveyor #6254

CLIENT
JOE
MACHEFSKI

TITLE
PROPERTY SURVEY - PT SW 1/4, SEC. 16
T 6 N R 12 E, TROY TOWNSHIP,
WOOD COUNTY, OHIO

SCALE
NO
DRAWN
L.A.

ASKINS · MERCER · ASSOC.
125 ELM ST. ————— CYGNET, OHIO

REF. NO
78109-S
DATE
18