

372
CENTER

PROPERTY SURVEY for DUANE VALENTINE
@ N.E. Corner of Cuckle Creek & Napoleon Eds.

T-5-N R-11-E SECTION 27
CENTER TOWNSHIP
WOOD COUNTY



CUCKLE CREEK ROAD - 40' R/W
Half Section
Line
R/W

N 1° 30' 30" E
306.62

194.55

± 158

795.12'

S 87° 37' 10" E

1.24 Acres ±

N 12° 30' 30" E
254.36

2.41 Acres ±

Oil Line R/W
Vol 273-298

339.11'
S 76° 04' 30" W

Center Line Napoleon Ed. S 73° 31' 30" W
492.24'
60' R/W

200.17
S 77° 15' 20" W

± 55

N 1° 30' 30" E
2,289.72

SOUTH 1/4 CORNER
SECTION 27

East 1/4 Corner
SECTION 27

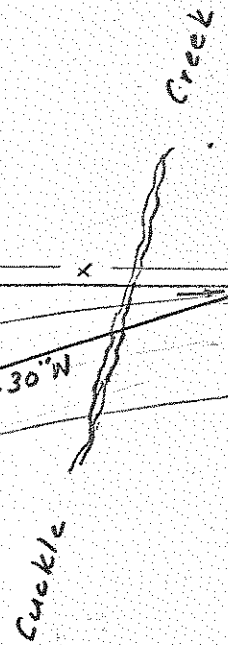

SCALE: 1" = 100'
○ Iron PIPE Set at Points
● P.K. Nails Set at Points

SURVEYED BY R. Brueckel, Jr.
Reg. SUR. 5374
APRIL 1967

372
CENTER