

B.G.
CORP
1008

S U R V E Y

of
Lots 1960, 1961, 1962, W $\frac{1}{2}$ Forest St.
Bowling Green, O.

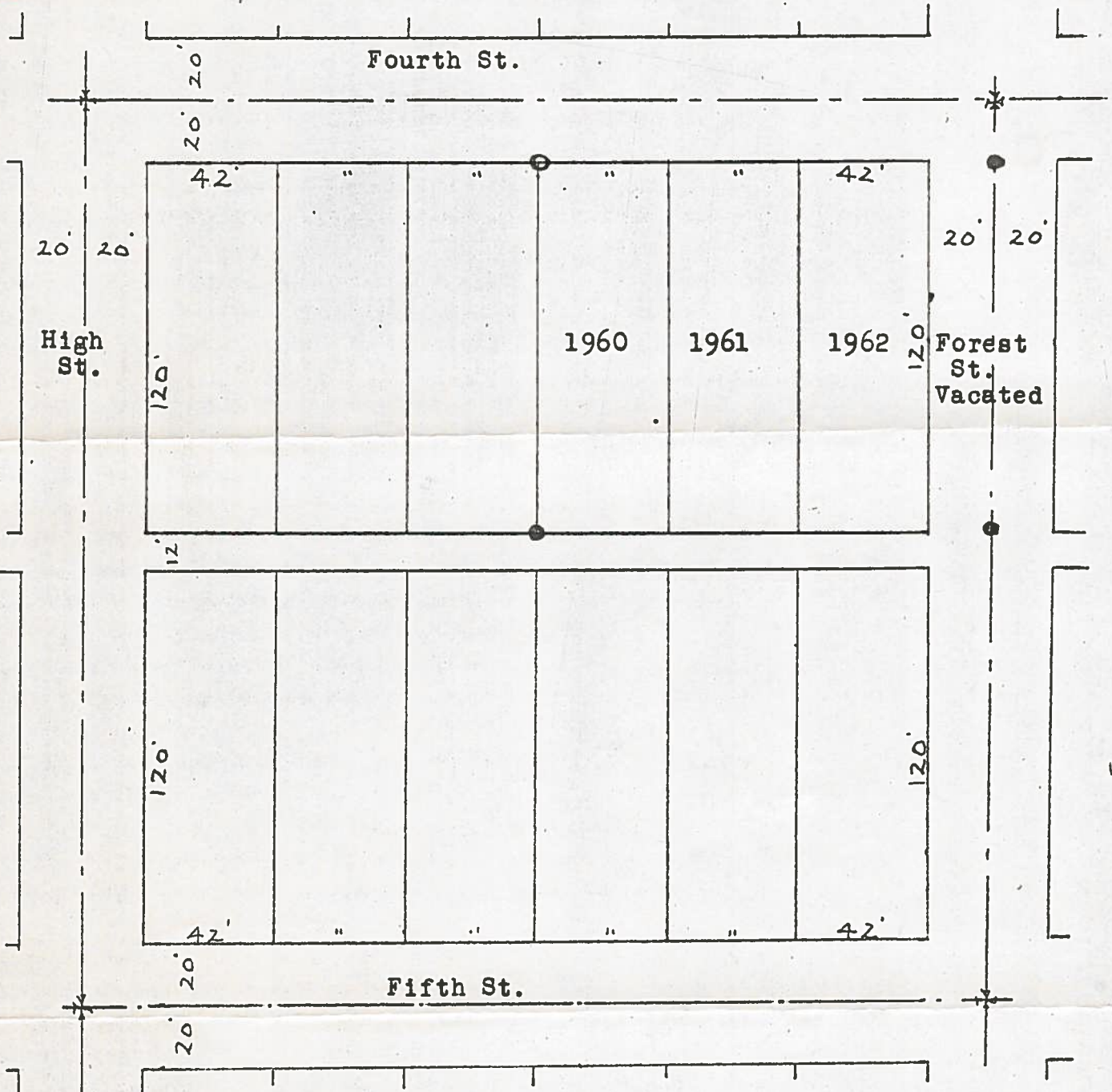

Control points shown thus *

Iron pipe found at point shown thus o

Iron pins set at points shown thus •

Surveyed by H. Morgan
June 1970 Reg. Sur. 890

B.G.
CORP
1008