

CERTIFICATE OF SURVEY: TOWN 4, U.S.R. PART OF THE NE. 1/4 OF SECTION 2, PERRYSBURG TOWNSHIP, WOOD COUNTY, OHIO

NAD-83, GEOID 12A
PROJECT COORDS.
ARC GIS: 10.3

REFERENCE DOC'S

1. SURVEY BY PORTER McDONNELL, 1968 [LE FILES]
2. SURVEY BY BELL 1987, [201-364]
3. SURVEY BY LEWANDOWSKI ENGINEERS, 1992, [LE #30740]
4. SURVEY BY MOREE, UNDATED. [LE FILES]
5. SURVEY BY FWB, 1999, [201-703]
6. SURVEY BY PETERMAN, 1999, [201-683]
7. SURVEY BY SAXER, 2007, [201-838]
8. SURVEY BY LEWANDOWSKI ENGINEERS, 2010, [LE #43346]



CERTIFICATION

WE HEREBY CERTIFY THAT WE HAVE MADE A SURVEY OF THE PREMISES SHOWN HEREON AS RECORDED IN WOOD COUNTY DEED VOLUME 440, PAGE 543 AND THAT THIS DRAWING IS A CORRECT PLOT THEREOF. ALL 1/2" GALVANIZED STEEL PIPE SET BY LEWANDOWSKI ENGINEERS ARE CAPPED WITH THE COMPANY NAME AND P.L.S. No. 7476.

[Signature]
REGISTERED SURVEYOR, STATE OF OHIO #7476

STEVENSON ACRES, LLC.
PAR: P57-400-02000008000
O.R.V. 3365, P.406

FD. 1/2" I.P.I.PE
N 3225.31
E 6089.69

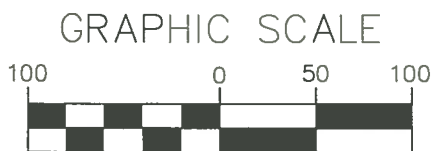
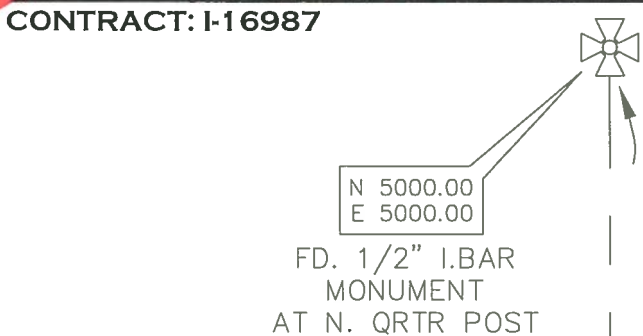

(IN FEET)
1 inch = 100 ft.

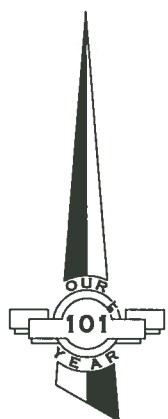

GLENWOOD ROAD
(60' R/W)

SET. 1/2" GALV. STEEL PIPE
N 3208.01
E 5030.00

N00°00'00"E
29.26'
P.D.B. SPLIT

W. LINE NE. 1/4 SEC. 2 T.4 U.S.R.
N00°00'00"E
329.13'

P.D.B. REMAINDER

FD. PK NAIL AT CENTER OF SECTION PER WOOD COUNTY REFERENCE
N 2651.19
E 5000.00

P.D.C.

FD. 1/2" I.P.I.PE
0.07' E. OF R/W
N 3237.27
E 5030.00

FENCE 2.4' N GATE
FENCE 0.4' S GATE
SPLIT R/W
877.93 SQ FT
0.020 AC

REMAINDER R/W
9,873.88 SQ FT
0.227 AC

30' R/W

FD. 1/2" I.P.I.PE
0.05' E. OF R/W
N 2878.88
E 5030.00

S89°21'11"E 1089.76'

S89°21'11"E 537.50'

REMAINDER
176,904.14 SQ FT
4.061 AC

JERRY & HELEN KRALL
PAR: P57-400-020000011000
D.V.440, P.543

FENCE 0.4' N
537.50'

N89°20'56"W 940.55'

LEE & TERRI STEWART
PAR: P57-400-020000012000
O.R.V. 2876, P.1100

GENERATION PIPELINE
N 3202.28
E 5537.46
SET. 1/2" GALV. STEEL PIPE

SPLIT
186,932.09 SQ FT
4.291 AC

S00°00'00"E 329.17'
N 2873.11
E 5537.46
SET. 1/2" GALV. STEEL PIPE

N 2868.53
E 5940.48
FD. 1/2" I.P.I.PE

NEW YORK LINES, LLC
S22°41'42"W 386.72'
P57-400-02000920200
D.V.763 P.432

LEGEND

- C/L ————
- PROPERTY LINE —————
- R/W ————
- FENCE ——— x ———



LEWANDOWSKI ENGINEERS

CIVIL ENGINEERS & SURVEYORS
THE CHIEF BLDG 234 N. ERIE ST.
TOLEDO, OHIO, 43604
LEWANDOWSKIENG.COM
OFFICE: 419.255.4111

P-3094
1174