

GENERAL NOTES:

STORMWATER POLLUTION PREVENTION PLAN (SWP3) NOTES

1.

ALL WORK SHALL BE IN ACCORDANCE WITH OHIO EPA NPDES CONSTRUCTION STORM WATER GENERAL PERMIT (NO: OHCO00004). SOIL EROSION CONTROL MEASURES SHALL CONFORM WITH THE SPECIFICATIONS OF OHIO'S RAINWATER AND LAND DEVELOPMENT MANUAL BEST MANAGEMENT PRACTICES (BMP).
2.

AN SWP3 IS REQUIRED FOR ALL PROJECTS AND MUST BE MAINTAINED ON SITE AT ALL TIMES DURING CONSTRUCTION ACTIVITIES.
3.

CONTRACTOR SHALL PROVIDED COPY OF OHIO EPA PERMIT IN ONSITE SWPPP LOG BOOK OR ONSITE COMPUTER.
4.

A NOTICE OF INTENT (NOI) APPLICATION MUST BE FILED WITH THE OHIO EPA FOR ALL PROJECTS THAT DISTURB 1 ACRE OR MORE AT LEAST 21 DAYS PRIOR TO THE START OF ANY CONSTRUCTION ACTIVITY.

a.

ALL "OPERATORS" MUST OBTAIN PERMIT COVERAGE BEFORE BREAKING GROUND. THIS INCLUDES CONTRACTORS ASSOCIATED WITH AND RESPONSIBLE FOR THE SOIL EROSION ACTIVITIES.

b.

ANY PARTY (TYPICALLY THE GENERAL CONTRACTOR) WHO HAS DAY-TO-DAY OPERATIONAL CONTROL OF ACTIVITIES AT THIS PROJECT, WHICH ARE NECESSARY TO ENSURE COMPLIANCE WITH THE SWP3 FOR THE SITE OR OTHER CONDITIONS AS SET FORTH IN THE PERMIT, MUST FILE A CO-PERMITTEE NOI WITH THE OHIO EPA. THIS IS THE SOLE RESPONSIBILITY OF THE CO-PERMITTEE AND SHALL BE DONE 21 DAYS BEFORE GROUND IS BROKEN.
5.

THE CONTRACTOR/BUILDER FOR HOUSES IN RESIDENTIAL SUBDIVISIONS MUST FILE AN INDIVIDUAL LOT NOI WITH THE OHIO EPA PRIOR TO THE START OF CONSTRUCTION.
6.

THE CONTRACTOR SHALL PROVIDE REGULAR INSPECTIONS AND MAINTENANCE FOR ALL SOIL EROSION CONTROL PRACTICES.
7.

SOIL EROSION AND SEDIMENTATION BEST MANAGEMENT PRACTICE (BMP) MEASURES WILL BE INSTALLED PRIOR TO START OF ANY CONSTRUCTION AND WILL BE MAINTAINED AT ALL TIMES UNTIL CONSTRUCTION HAS BEEN COMPLETED, INCLUDING ALL GRASS BEING WELL ESTABLISHED AND/OR PERMANENT EROSION AND SEDIMENTATION BMP MEASURES ARE IN PLACE. ALL BMP MEASURES WILL BE INSTALLED TO THE SATISFACTION OF WOOD COUNTY.
8.

CONTRACTOR SHALL INSTALL A STABILIZED CONSTRUCTION ENTRANCE TO CONTROL EROSION PRIOR TO COMMENCEMENT OF ANY EARTHWORK OPERATIONS. DRIVEWAY SURFACE SHALL BE COMPOSED OF 6" CLEAN AGGREGATE. CONTRACTOR SHALL BE RESPONSIBLE FOR MAINTENANCE OF THIS ACCESS ROUTE WHEN CONDITIONS WARRANT.
9.

SOLID, SANITARY AND TOXIC WASTE MUST BE DISPOSED OF IN A PROPER MANNER IN ACCORDANCE WITH LOCAL, STATE AND FEDERAL REGULATIONS. ALL CONSTRUCTION & DEMOLITION DEBRIS (C&DD) WASTE WILL BE DISPOSED OF IN AN OHIO EPA APPROVED C&DD LANDFILL AS REQUIRED BY OHIO REVISED CODE (ORC) 3714. IT IS PROHIBITED TO BURN, BURY OR POUR ONTO THE GROUND OR INTO STORM SEWERS ANY SOLVENTS, PAINTS, STAINS, GASOLINE, DIESEL FUEL, USED MOTOR OIL, HYDRAULIC FLUID, ANTIFREEZE, CEMENT CURING COMPOUNDS AND OTHER SUCH TOXIC OR HAZARDOUS WASTES.
10.

CONTRACTOR IS TO DESIGNATE A SITE DUMP/WASH AREA PRIOR TO STARTING CONSTRUCTION FOR SUCH PURPOSES AS WASHING OUT CONCRETE TRUCKS AND DUMPING NON-HAZARDOUS WASTE MATERIALS, SUBJECT TO THE SUPERVISION OF LOCAL GOVERNING AGENCIES. DUMPING OR DISCHARGE OF ANY WASTE MATERIALS INTO ANY SEWER IS PROHIBITED. HAZARDOUS WASTES ARE TO BE REMOVED OFF SITE AND PROPERLY DISPOSED OF CONSISTENT WITH ALL FEDERAL, STATE AND LOCAL REGULATIONS.
11.

ALL TEMPORARY AND PERMANENT CONTROL PRACTICES MUST BE MAINTAINED AND REPAIRED TO ENSURE CONTINUED PERFORMANCE.
12.

PERIMETER SEDIMENT BARRIERS SHALL BE IMPLEMENTED AS THE FIRST STEP OF GRADING AND WITHIN 7 DAYS FROM THE START OF GRUBBING.
13.

ALL DISTURBED AREAS THAT WILL REMAIN DORMANT FOR MORE THAN 14 DAYS MUST BE TEMPORARILY STABILIZED WITHIN 7 DAYS.
14.

TEMPORARY INLET PROTECTION SHALL BE PROVIDED AND MAINTAINED THROUGHOUT THE DURATION OF CONSTRUCTION FOR ALL CATCH BASINS ON SITE.
15.

SHEET FLOW RUNOFF FROM DENUDED AREAS SHALL BE INTERCEPTED BY SEDIMENT BARRIERS.
16.

PERMANENT STABILIZATION SHALL BE APPLIED TO DISTURBED AREAS WITHIN 7 DAYS AFTER FINAL GRADE IS REACHED AND FOR AREAS THAT WILL LIE DORMANT FOR ONE YEAR OR MORE.
17.

CONSTRUCTION OPERATIONS SHALL BE SCHEDULED AND PERFORMED SO THAT PREVENTIVE SOIL EROSION CONTROL MEASURES ARE IN PLACE PRIOR TO EXCAVATION IN CRITICAL AREAS AND TEMPORARY STABILIZATION MEASURES ARE IN PLACE IMMEDIATELY FOLLOWING BACKFILLING OPERATIONS.
18.

CONTRACTOR SHALL PROVIDE ROUTINE STREET SWEEPING TO ENSURE MINIMAL EROSION INTO THE PUBLIC STORM SEWER SYSTEM AND ROADWAY.
19.

ALL DISTURBED AREAS THAT WILL BE LEFT IDLE OVER THE WINTER SHALL BE TEMPORARILY STABILIZED.
20.

A NOTICE OF TERMINATION (NOT) SHALL BE SUBMITTED WITHIN 45 DAYS OF COMPLETING ALL LAND DISTURBANCE ACTIVITIES.
21.

POST-CONSTRUCTION STORM WATER MANAGEMENT: STORM WATER DRAINAGE WILL SURFACE DRAIN TO THE DETENTION AREAS FOR THE DEVELOPED AREAS. AREAS NOT DEVELOPED WILL HAVE PERMANENT SEEDING OR PLANTINGS. AREAS OF THE SITE WILL REMAIN UNTOUCHED AND IN ITS NATURAL STATE. THE ENTIRE SITE WILL DRAIN TO THE DETENTION BASIN. WHEN AREAS ARE STABILIZED, THE ACCUMULATED SEDIMENT WILL BE REMOVED FROM THE BASIN.

- OTHER CONTROLS

22.

WASTE DISPOSAL: ALL WASTE MATERIALS WILL BE COLLECTED AND STORED IN A SECURELY LIDDED METAL DUMPSTER. ALL TRASH AND CONSTRUCTION DEBRIS FROM THE SITE WILL BE DEPOSITED IN THE DUMPSTER. THE DUMPSTER WILL BE EMPTIED AS OFTEN AS NECESSARY IN ACCORDANCE WITH STATE AND LOCAL CODES. NO CONSTRUCTION WASTE MATERIALS WILL BE BURIED ONSITE.
23.

HAZARDOUS WASTE: ALL HAZARDOUS WASTE MATERIALS WILL BE DISPOSED OF IN THE MANNER SPECIFIED BY LOCAL OR STATE REGULATION OR BY THE MANUFACTURER. SITE PERSONNEL WILL BE INSTRUCTED IN THESE PRACTICES AND THE INDIVIDUAL WHO MANAGES DAY-TO-DAY SITE OPERATIONS WILL BE RESPONSIBLE FOR SEEING THAT THESE PRACTICES ARE FOLLOWED. NO HAZARDOUS MATERIALS WILL LEAVE THE CONSTRUCTION SITE WITHOUT OWNER APPROVAL.
24.

SANITARY WASTE: ALL SANITARY WASTE WILL BE COLLECTED FROM THE PORTABLE UNITS A MINIMUM OF ONE TIME A WEEK BY A LICENSED SANITARY WASTE MANAGEMENT CONTRACTOR, AS REQUIRED BY LOCAL REGULATION.
25.

OFFSITE VEHICLE TRACKING: A STABILIZED CONSTRUCTION ENTRANCE HAS BEEN PROVIDED TO HELP REDUCE VEHICLE TRACKING OF SEDIMENTS. THE PAVED STREET ADJACENT TO THE SITE ENTRANCE WILL BE MAINTAINED TO REMOVE ANY EXCESS MUD, DIRT OR ROCK TRACKED FROM THE SITE. DUMP TRUCKS HAULING MATERIAL FROM THE CONSTRUCTION SITE WILL BE COVERED WITH A TARPULIN.
26.

A SPILL POLLUTION CONTROL & COUNTERMEASURES PLAN SHALL BE DEVELOPED FOR ABOVE GROUND STORAGE TANK (AST) OF 660 GALLONS OR MORE, OR A TOTAL OF 1330 GALLONS OF STORAGE, OR BELOW GROUND STORAGE OF 42,000 GALLONS.
27.

MAINTENANCE/INSPECTION PROCEDURE

EROSION AND SEDIMENT CONTROL INSPECTION AND MAINTENANCE PRACTICES: THE CONTRACTOR WILL PERFORM AND DOCUMENT THE FOLLOWING MAINTENANCE AND INSPECTION PROCEDURES:

a.

LESS THAN ONE HALF OF THE SITE WILL BE DENUDED AT ONE TIME

b.

ONLY QUALIFIED INSPECTION PERSONNEL WILL PERFORM THE INSPECTION

c.

ALL CONTROL MEASURES WILL BE INSPECTED AT LEAST ONCE EACH WEEK AND FOLLOWING ANY STORM EVENT OF 0.5 INCHES OR GREATER.

d.

ALL MEASURES WILL BE MAINTAINED IN GOOD WORKING ORDER; IF REPAIR IS NECESSARY, IT WILL BE INITIATED WITHIN 24 HOURS OF THE REPORT.

e.

BUILT UP SEDIMENT WILL BE REMOVED FROM SILT FENCE WHEN IT HAS REACHED ONE-THIRD THE HEIGHT OF THE FENCE.

f.

SILT FENCE WILL BE INSPECTED FOR DEPTH OF SEDIMENT, TEARS, TO SEE IF THE FABRIC IS SECURELY ATTACHED TO THE FENCE POSTS, AND TO SEE THAT THE FENCE POSTS ARE FIRMLY IN THE GROUND.

g.

NON SEDIMENT POND BMP'S WILL BE REPAIRED WITHIN 3 DAYS OF INSPECTION AND SEDIMENT PONDS SHALL BE REPAIRED OR CLEANED OUT WITHIN 10 DAYS OF INSPECTION

h.

BUILT UP SEDIMENT IN THE DRAINAGE SWALES WILL BE REMOVED.

i.

TEMPORARY AND PERMANENT SEEDING AND PLANTING WILL BE INSPECTED FOR BARE SPOTS, WASHOUTS, AND HEALTHY GROWTH.

j.

A MAINTENANCE INSPECTION REPORT WILL BE MADE AFTER EACH INSPECTION.

k.

THE INSPECTOR WILL BE RESPONSIBLE FOR THE INSPECTIONS, INFORMING THE CONTRACTOR OF NEEDED REPAIRS, SUPERVISING SUCH REPAIRS AND FILLING OUT THE INSPECTION AND MAINTENANCE REPORT.

l.

THE INSPECTION AND MAINTENANCE REPORT WILL BE SIGNED BY THE QUALIFIED INSPECTION PERSONNEL AFTER EACH INSPECTION

m.

MISSING OR NON-FUNCTIONAL BMP'S WILL BE INSTALLED OR CORRECTED WITHIN 10 DAYS OF THE INSPECTION.

n.

THE PERMITTEE SHALL MAINTAIN FOR THREE YEARS FOLLOWING THE SUBMITTAL OF A NOTICE OF TERMINATION FORM, A RECORD SUMMARIZING THE RESULTS OF THE INSPECTIONS.

o.

IF THE SITE WILL BE DORMANT FOR A LONG PERIOD, AND IS STABILIZED, A WAIVER REQUEST CAN BE SUBMITTED TO THE OEPA FOR A REDUCTION IN MONTHLY INSPECTIONS.

p.

WATER QUALITY PONDS SHALL BE CLEANED OF TRASH AND DEBRI MONTHLY.

q.

WATER QUALITY PONDS SHALL BE INSPECTED ANNUALLY FOR OUTLET FLOW AND DAMAGE TO THE OUTLET STRUCTURE. REMOVE WOODY VEGETATION AND FIX ERODING AREAS.

r.

WATER QUALITY PONDS SHALL BE MONITORED EVERY 15 TO 20 YEARS FOR SEDIMENT ACCUMULATIONS.
28.

SPILL CONTROL PRACTICES

a.

MANUFACTURERS' RECOMMENDED METHODS FOR SPILL CLEANUP WILL BE CLEARLY POSTED AND SITE PERSONNEL WILL BE MADE AWARE OF THE PROCEDURES AND THE LOCATION OF THE INFORMATION AND CLEANUP SUPPLIES.

b.

MATERIALS AND EQUIPMENT NECESSARY FOR SPILL CLEANUP WILL BE KEPT IN THE MATERIAL STORAGE AREA ONSITE. EQUIPMENT AND MATERIALS WILL INCLUDE BUT NOT LIMITED TO BROOMS, DUST PANS, MOPS, RAGS, GLOVES, GOGGLES, KITTY LITTER, SAND, SAWDUST, AND PLASTIC AND METAL TRASH CONTAINERS SPECIFICALLY FOR THIS PURPOSE.

c.

ALL SPILLS WILL BE CLEANED UP IMMEDIATELY AFTER DISCOVERY.

d.

THE SPILL AREA WILL BE KEPT WELL VENTILATED AND PERSONNEL WILL WEAR APPROPRIATE PROTECTIVE CLOTHING TO PREVENT INJURY FROM CONTACT WITH A HAZARDOUS SUBSTANCE.

e.

SPILLS OF TOXIC OR HAZARDOUS MATERIAL WILL BE REPORTED TO THE APPROPRIATE STATE OR LOCAL GOVERNMENT AGENCY, REGARDLESS OF THE SIZE.

f.

THE SPILL PREVENTION PLAN WILL BE ADJUSTED TO INCLUDE

- MEASURES TO PREVENT THIS TYPE OF SPILL FROM REOCCURRING AND HOW TO CLEAN UP THE SPILL IF THERE IS ANOTHER ONE. A DESCRIPTION OF THE SPILL, WHAT CAUSED IT, AND THE CLEANUP MEASURES WILL ALSO BE INCLUDED.

g.

THE SITE SUPERINTENDENT RESPONSIBLE FOR THE DAY-TO-DAY SITE OPERATIONS, WILL BE THE SPILL PREVENTION AND CLEANUP COORDINATOR. HE WILL DESIGNATE AT LEAST THREE OTHER SITE PERSONNEL WHO WILL RECEIVE SPILL PREVENTION AND CLEANUP TRAINING. THESE INDIVIDUALS WILL EACH BECOME RESPONSIBLE FOR A PARTICULAR PHASE OF PREVENTION AND CLEANUP. THE NAMES OF RESPONSIBLE SPILL PERSONNEL WILL BE POSTED IN THE MATERIAL STORAGE AREA AND IN THE OFFICE TRAILER ONSITE.
29.

GOOD HOUSEKEEPING

a.

AN EFFORT WILL BE MADE TO STORE ONLY ENOUGH PRODUCT REQUIRED TO DO THE JOB

b.

ALL MATERIALS STORED ONSITE WILL BE STORED IN A NEAT, ORDERLY MANNER IN THEIR APPROPRIATE CONTAINERS AND, IF POSSIBLE, UNDER A ROOF OR OTHER ENCLOSURE

c.

PRODUCT WILL BE KEPT IN THEIR ORIGINAL CONTAINERS WITH THE ORIGINAL MANUFACTURER'S LABEL

d.

SUBSTANCES WILL NOT BE MIXED WITH ONE ANOTHER UNLESS RECOMMENDED BY THE MANUFACTURER

e.

WHENEVER POSSIBLE, ALL OF A PRODUCT WILL BE USED UP BEFORE DISPOSING OF THE CONTAINER

f.

MANUFACTURERS' RECOMMENDATIONS FOR PROPER USE AND DISPOSAL WILL BE FOLLOWED

g.

THE SITE SUPERINTENDENT WILL INSPECT DAILY TO ENSURE PROPER USE AND DISPOSAL OF MATERIALS ONSITE

30.

SEDIMENT SETTLING PONDS (WHEN REQUIRED) SHALL BE INSTALLED AS THE FIRST STEP OF GRADING AND WITHIN 7 DAYS FROM THE START OF GRADING.
31.

CONCENTRATED STORM RUNOFF FROM DISTURBED AREAS FLOWING AT RATES WHICH EXCEED THE DESIGN CAPACITY OF SEDIMENT BARRIERS MUST PASS THROUGH A SEDIMENT SETTLING POND.
32.

DISTURBED AREAS IN RESIDENTIAL SUBDIVISIONS MUST BE STABILIZED AT LEAST 7 DAYS PRIOR TO TRANSFER OF PERMIT COVERAGE FOR THE INDIVIDUAL LOTS.
33.

SPECIAL PRECAUTIONS WILL BE TAKEN IN THE USE OF CONSTRUCTION EQUIPMENT TO PREVENT OPERATIONS WHICH PROMOTE EROSION.
34.

CLEANUP WILL BE CONDUCTED IN A MANNER TO ENSURE THAT EROSION CONTROL MEASURES ARE NOT DISTURBED.
35.

STOCKPILED SOILS SHALL BE LEGALLY REMOVED FROM THE SITE OR SEEDED AND SURROUNDED WITH SILT FENCE UNTIL SUCH TIME THAT IT CAN BE REUSED ON SITE.

SPECIFICATIONS FOR
SMALL LOT BUILDING SITES

1.

PREEXISTING VEGETATION SHALL BE RETAINED ON IDLE PORTIONS OF THE BUILDING LOT FOR AS LONG AS CONSTRUCTION OPERATIONS ALLOW. CLEARING SHALL BE DONE SO ONLY ACTIVE WORKING AREAS ARE BARE.
2.

TEMPORARY SEED (ANNUAL RYE, OATS, ETC.) AND/OR MULCH SHALL BE APPLIED TO AREAS, SUCH AS STOCKPILES, THAT ARE BARE AND NOT ACTIVELY BEING WORKED. THIS SHALL APPLY TO AREAS THAT WILL NOT BE REWORKED FOR 14 DAYS OR MORE.
3.

STOCKPILES EXCAVATED FROM BASEMENTS SHALL BE SITUATED AWAY FROM STREETS. SWALES, OR OTHER WATERWAYS AND SHALL BE SEEDED AND/OR MULCHED.
4.

SILT FENCE SHALL CONTROL SHEET FLOW RUNOFF FROM THE BUILDING LOT. IT SHALL NOT BE CONSTRUCTED IN CHANNELS OR AREAS OF CONCENTRATED FLOW. OTHER SEDIMENT CONTROLS SUCH AS INLET PROTECTION AND SEDIMENT TRAPS SHALL ALSO BE USED AS NEEDED TO CONTROL SEDIMENT RUNOFF.
5.

CONSTRUCTION VEHICLE ACCESS SHALL BE LIMITED TO ONE ROUTE, TO THE GREATEST EXTENT PRACTICAL. THE ACCESS SHALL BE GRAVEL OR CRUSHED ROCK APPLIED TO THE DRIVEWAY AREA.
6.

MUD TRACKED ONTO THE STREET OR SEDIMENT SETTLED AROUND CURB INLET PROTECTION SHALL BE REMOVED DAILY OR AS NEEDED TO PREVENT IT FROM ACCUMULATING. IT SHALL BE REMOVED BY SHOVELING AND SCRAPING AND SHALL NOT BE WASHED OFF PAVED SURFACES OR INTO STORM DRAINS.
7.

THE HOME BUILDER SHALL INSTALL AND MAINTAIN A "GRAVEL" CONSTRUCTION ENTRANCE TO CONTROL THE TRACKING OF DEBRIS ONTO PUBLIC ROADS. IT SHALL CONSIST OF A MINIMUM OF 6" OF 2" TO 3" SIZE STONE, 14 FEET WIDE AND 30 FEET IN LENGTH.

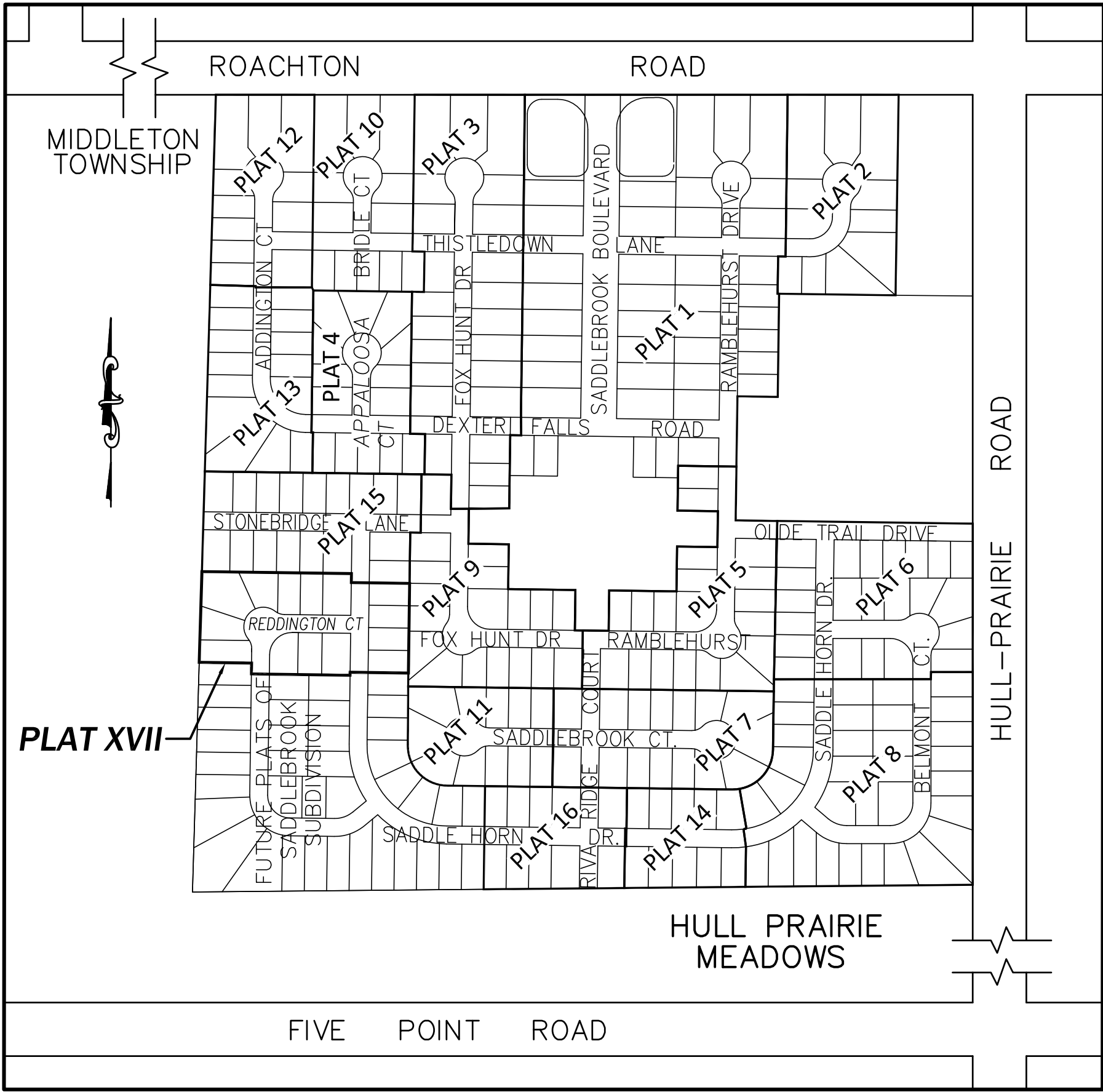

VICINITY MAP
1"=400'

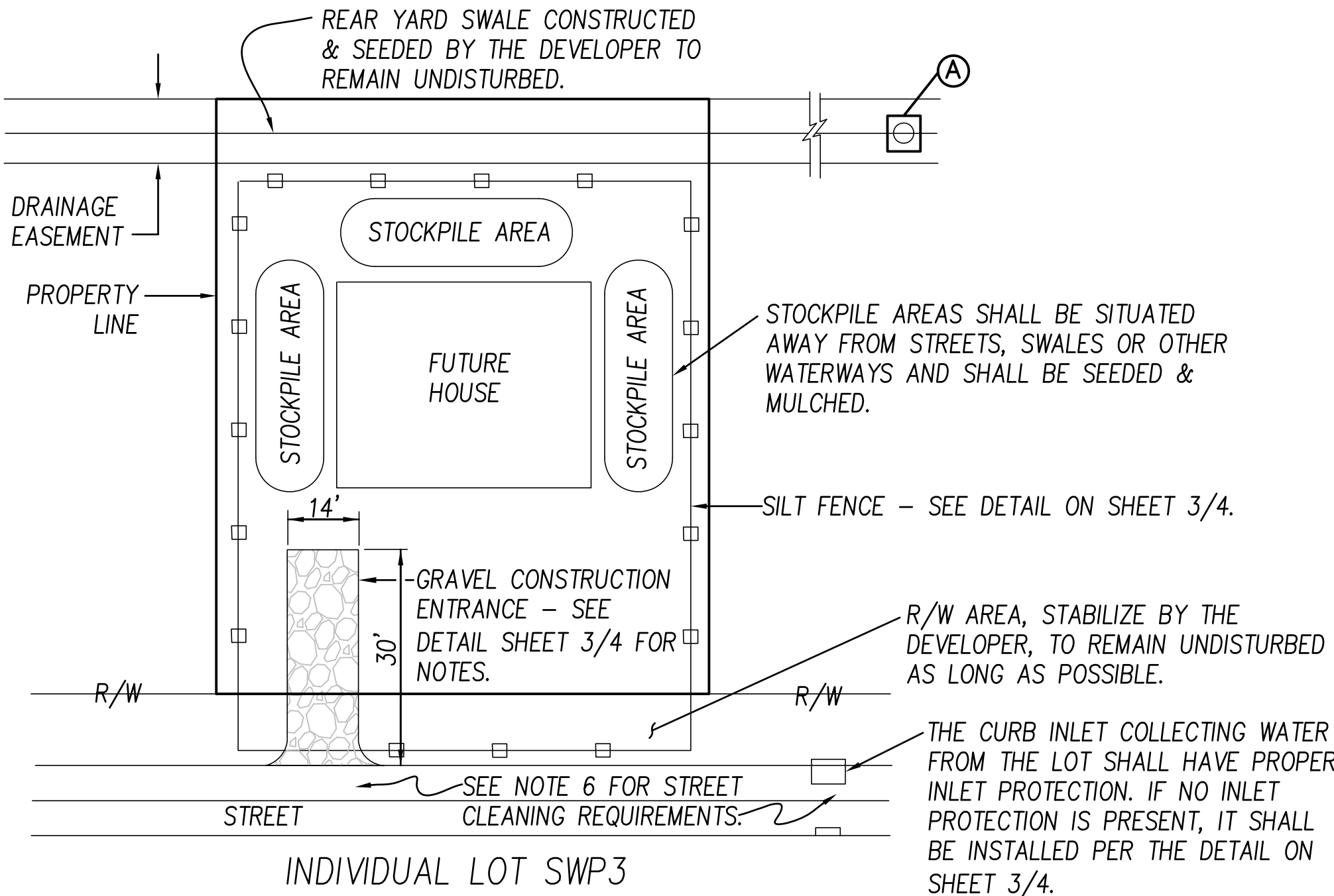

TYPICAL MAINTENANCE ACTIVITIES FOR WATER QUALITY PONDS

SCHEDULE	ACTIVITY
MONTHLY	MOW EMBANKMENT AND CLEAN TRASH AND DEBRIS FROM OUTLET STRUCTURE. ADDRESS ANY ACCUMULATION OF HYDROCARBONS.
ANNUALLY	INSPECT EMBANKMENT AND OUTLET STRUCTURE FOR DAMAGE AND PROPER FLOW. REMOVE WOODY VEGETATION AND FIX ANY ERODING AREAS. MONITOR SEDIMENT ACCUMULATIONS IN FOREBAY AND MAIN POOL.
SEMI-ANNUALLY	INSPECT WETLAND AREAS FOR INVASIVE PLANTS.
3-7 YEARS	REMOVE SEDIMENT FROM FOREBAYS.
15-20 YEARS	MONITOR SEDIMENT ACCUMULATIONS IN THE MAIN POOL AND CLEAN AS POND BECOMES EUTROPHIC OR POND VOLUME IS REDUCED SIGNIFICANTLY.